

PRELIMINARY

OUTDOOR LIVING DESIGNS

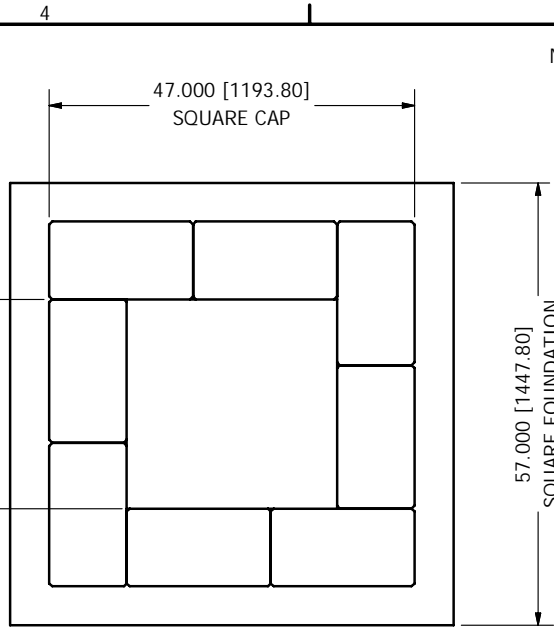

TOP VIEW

NOTE:

1. WALL UNITS TO BE INSTALLED WITH CHANNEL ON THE BOTTOM SIDE IN ORDER TO GET THE PROPER CONTEMPORARY ESTHETIC LOOK. (WALL PRODUCT TO BE INVERTED 180 DEGREES FROM FINISHED PALLET WHEN INSTALLED).
2. SECURE EACH UNIT USING APPROVED ADHESIVE OR BONDING AGENT FOLLOWING APPLICATION DIRECTIONS PROVIDED BY PRODUCT SUPPLIER.

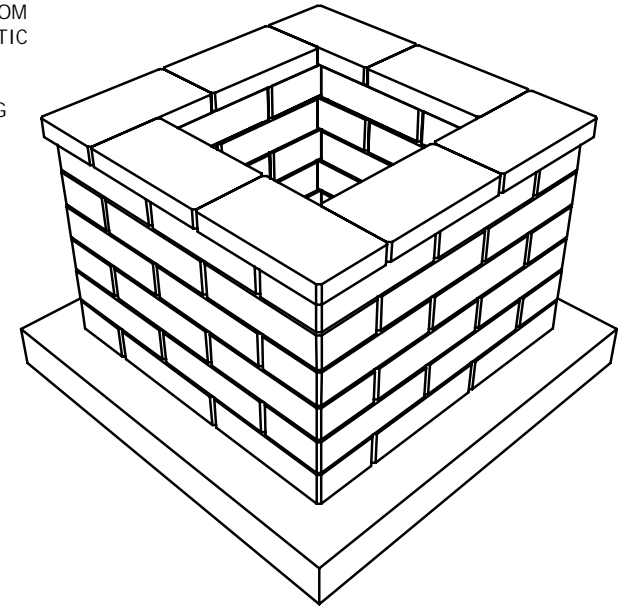

ISOMETRIC VIEW

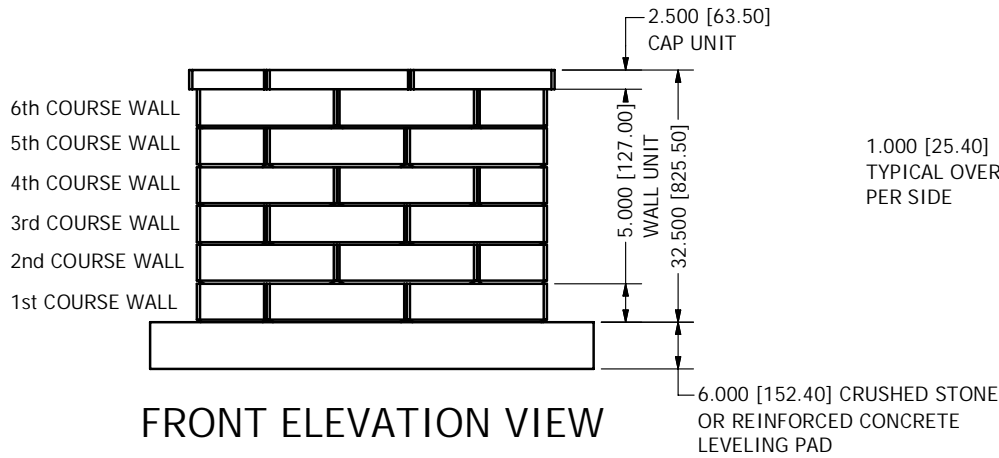

FRONT ELEVATION VIEW

1.000 [25.40] TYPICAL OVERHANG PER SIDE

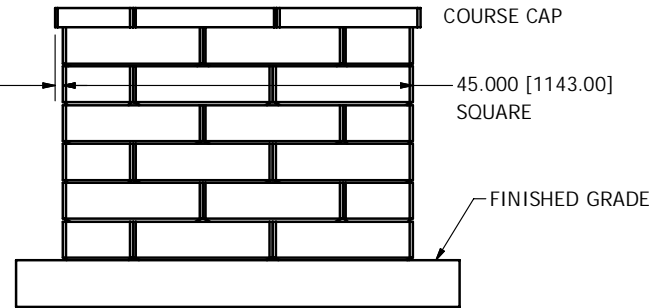

SIDE ELEVATION VIEW

PRODUCT COUNTS:
 (48) TOTAL WALL UNITS
 (8) TOTAL CAP UNITS

PRELIMINARY

OUTDOOR LIVING DESIGNS

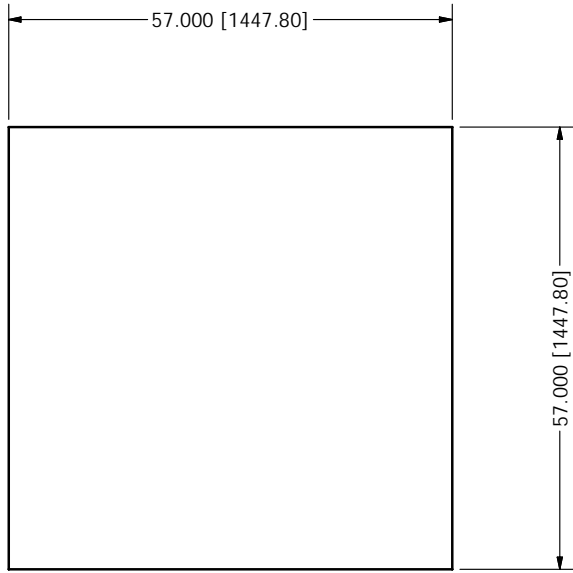

PLAN VIEW

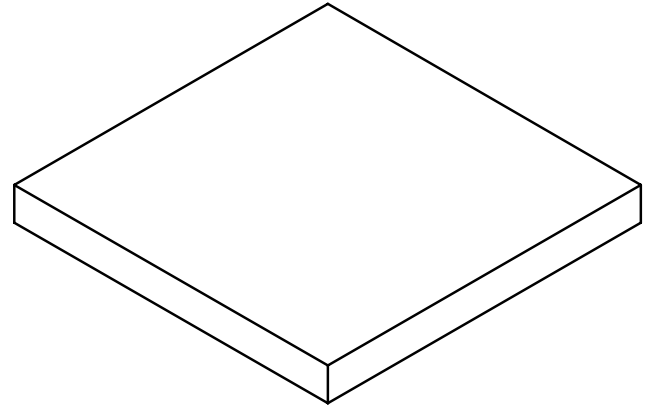

ISOMETRIC VIEW



FRONT ELEVATION VIEW

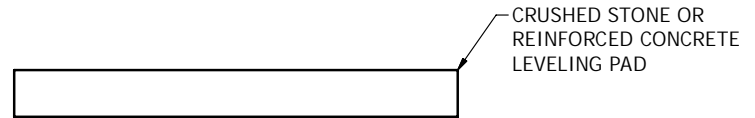

SIDE ELEVATION VIEW

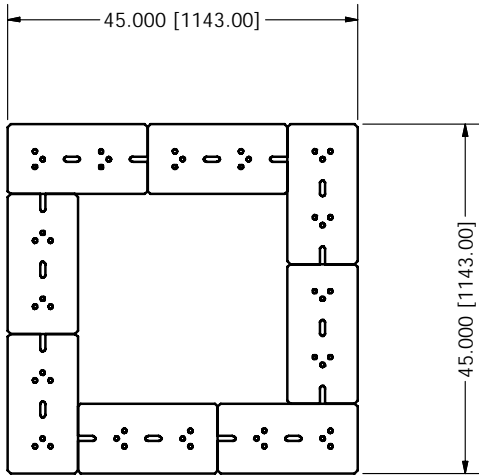

PLAN VIEW

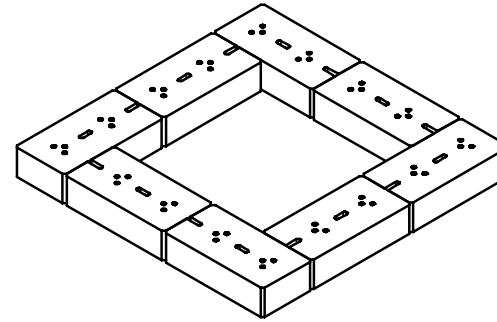

ISOMETRIC VIEW

NOTE:
 1. WALL UNITS TO BE INSTALLED WITH CHANNEL ON THE BOTTOM SIDE
 (PRODUCT IS TO BE INVERTED 180 DEGREES FROM FINISHED PALLET).

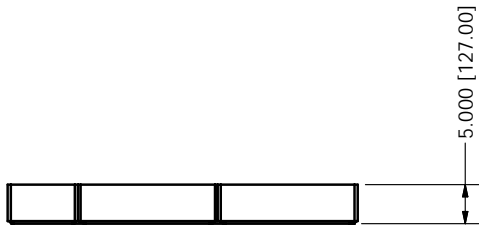

FRONT ELEVATION VIEW



SIDE ELEVATION VIEW

PRODUCT COUNTS:
 (8) TOTAL WALL UNITS

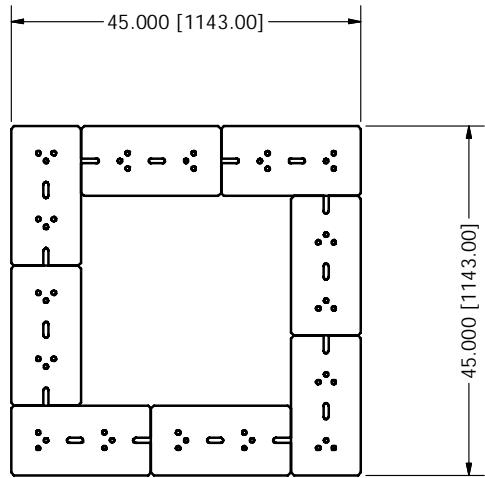

PLAN VIEW

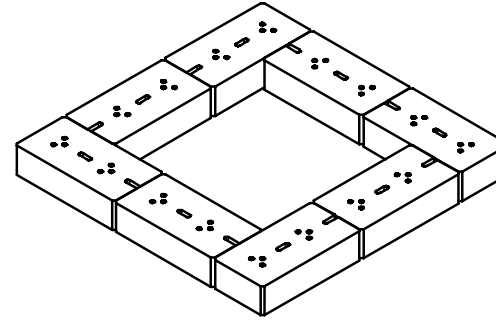

ISOMETRIC VIEW

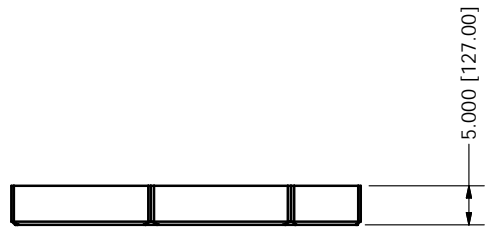

FRONT ELEVATION VIEW



SIDE ELEVATION VIEW

NOTE:

1. WALL UNITS TO BE INSTALLED WITH CHANNEL ON THE BOTTOM SIDE (PRODUCT IS TO BE INVERTED 180 DEGREES FROM FINISHED PALLET).

PRODUCT COUNTS:
(8) TOTAL WALL UNITS

PRELIMINARY

OUTDOOR LIVING DESIGNS

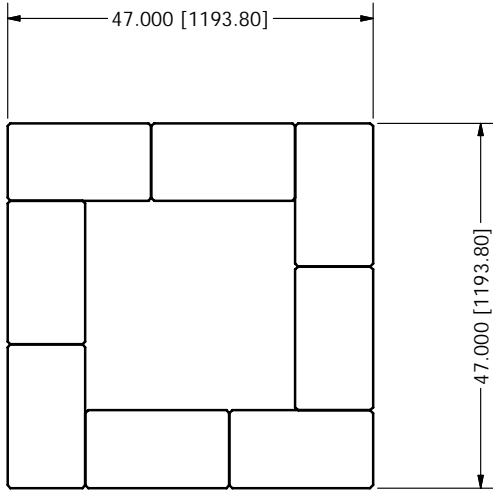

PLAN VIEW

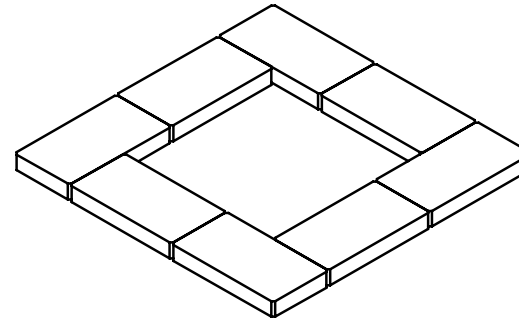

ISOMETRIC VIEW

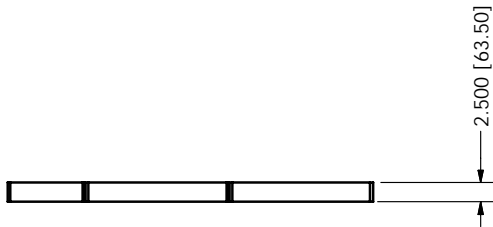

FRONT ELEVATION VIEW

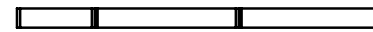

SIDE ELEVATION VIEW

PRODUCT COUNTS:
(8) TOTAL CAP UNITS